

Τεχνικές πληροφορίες - Πώς να επιβεβαιώσετε τη θέση της οπής

H	Χώρος ντουλαπιού	Εγκατάσταση μπροστινού πίνακα	Διάτρηση μπροστινού πίνακα	Εγκατάσταση πίσω πάνελ
84				
116				
167				
199				

Τεχνικές πληροφορίες - Πώς να επιβεβαιώσετε τη θέση της οπής ολίσθησης και τις διαστάσεις κοπής

Θέσεις στερέωσης για συρταριές

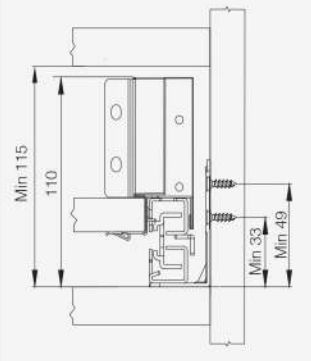
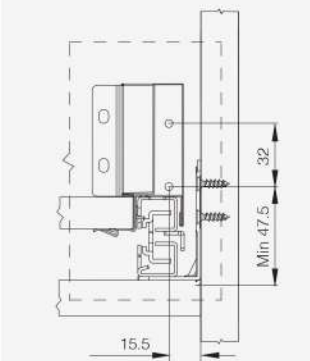
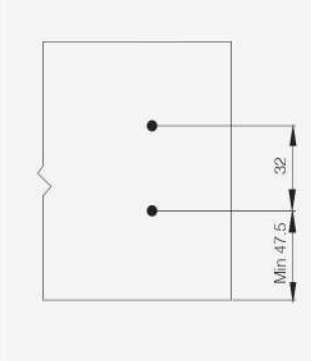
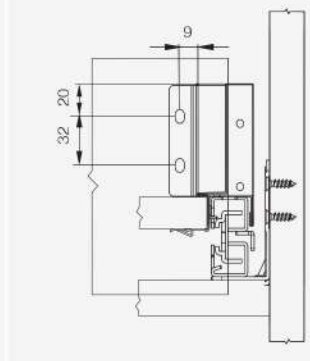
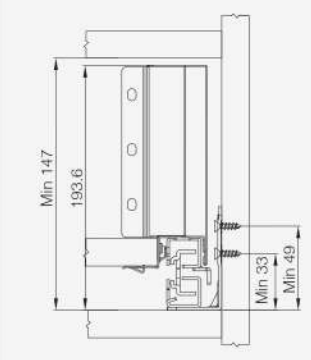
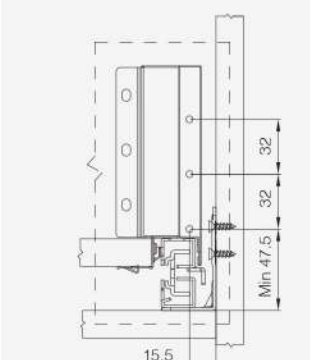
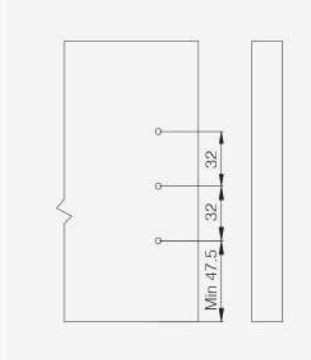
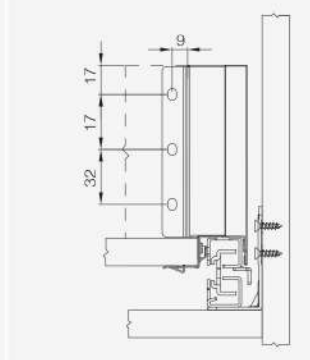
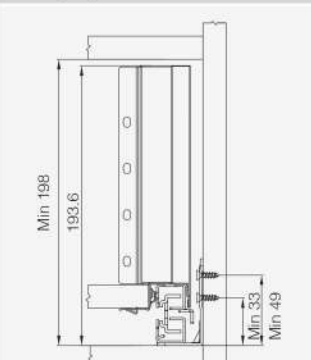
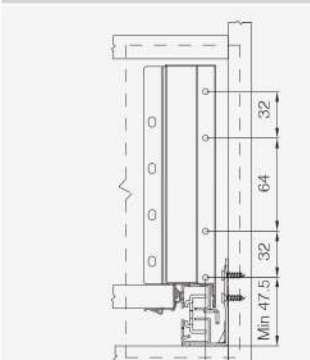
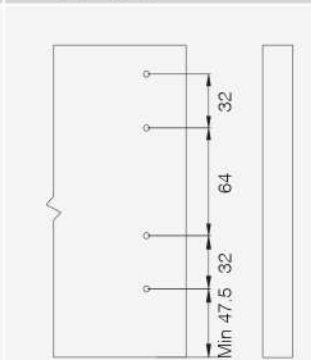
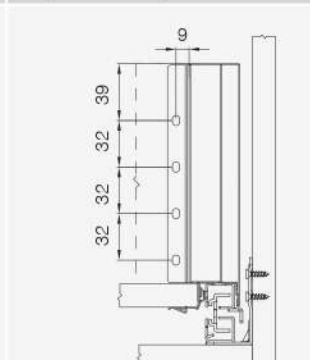
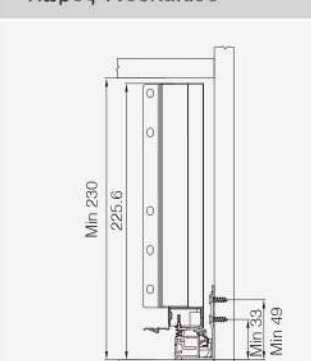
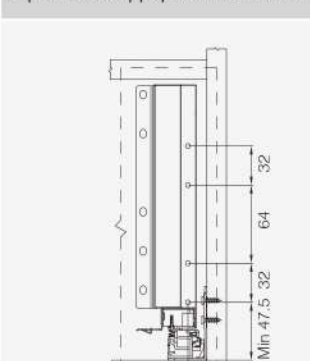
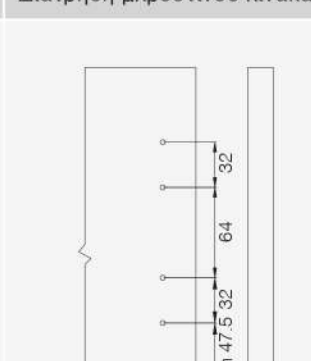
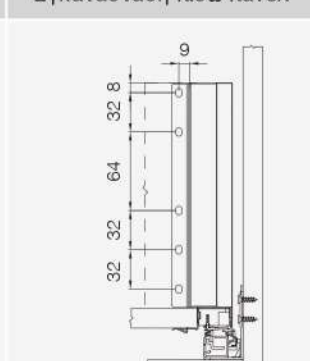
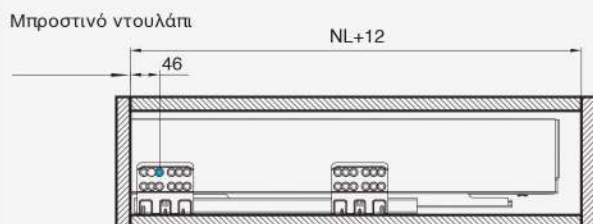
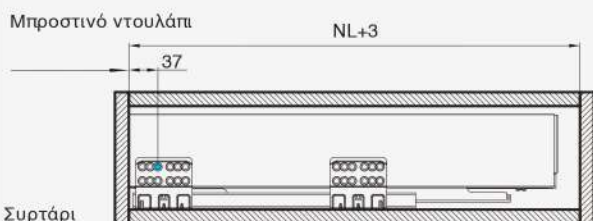
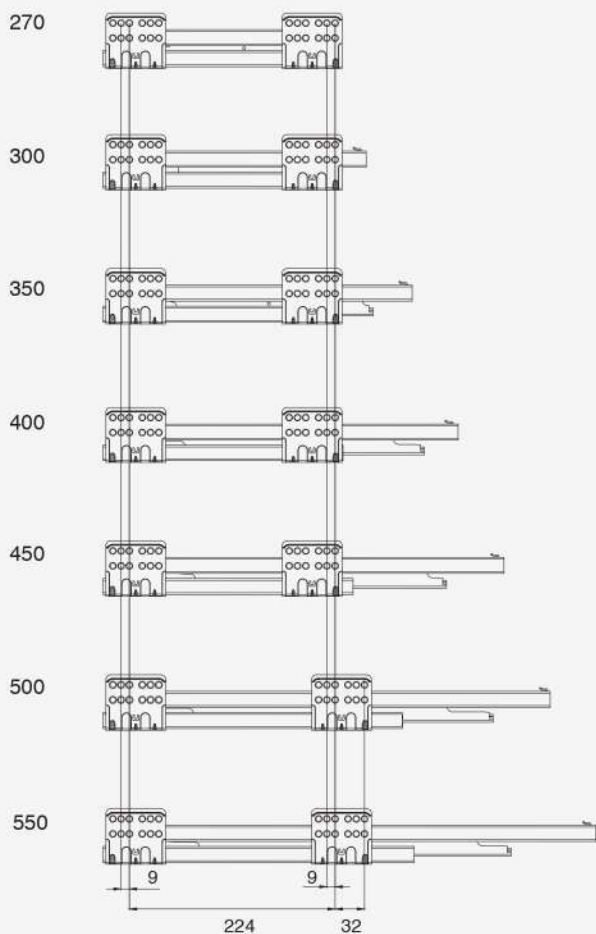

Ένθετο συρτάρι

Διαστάσεις κοπής για MDF 16mm

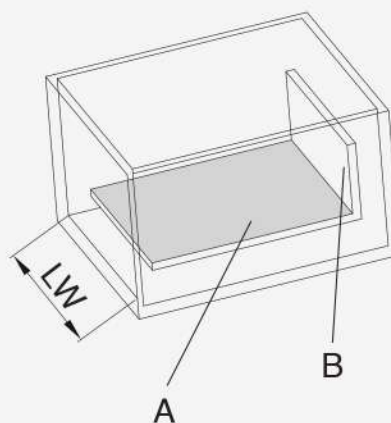

Διάσταση κοπής κάτω πάνελ

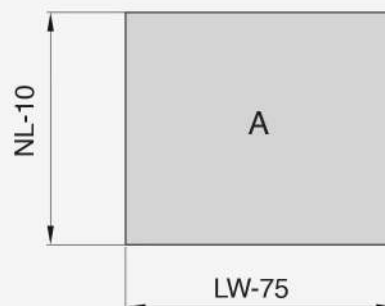

Διάσταση κοπής πίσω πάνελ

B	H	H	H1
		84	68
		116	100
		167	151
LW-87	H	199	183

* Συνιστάται ο μπροστινός πίνακας

Πλάτος ≤ 1200mm

Υψος ≤ 400mm

Legend

LW Εσωτερικό πλάτος ντουλαπιού L Μήκος

NL Ονομαστικό μήκος KB Πλάτος ντουλαπιού

Η box

Πληροφορίες εγκατάστασης

Τοποθετήστε το συρτάρι

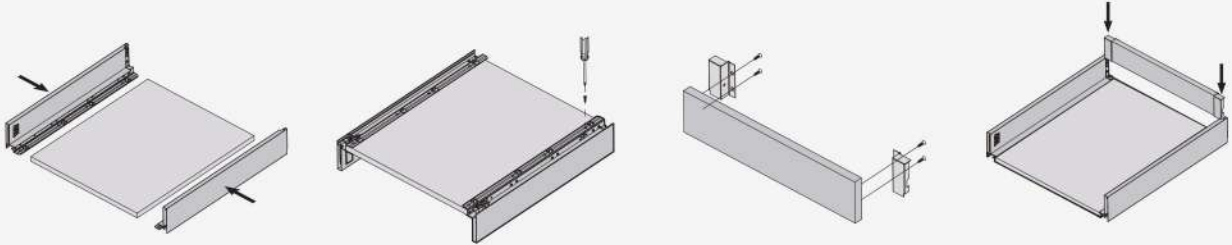

Εγκαταστήστε τον πίνακα H84 & H116

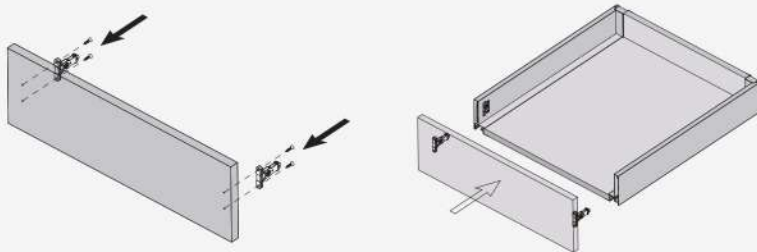

Εγκαταστήστε τον πίνακα H167 & H199

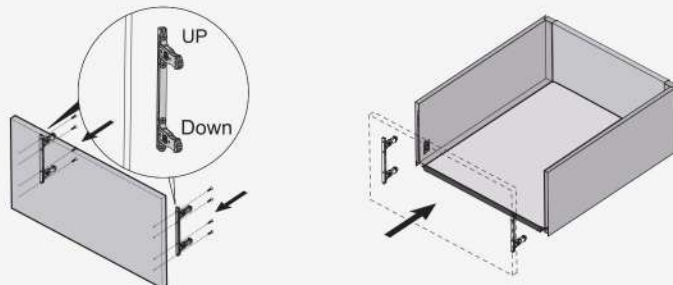

Προσαρμογή

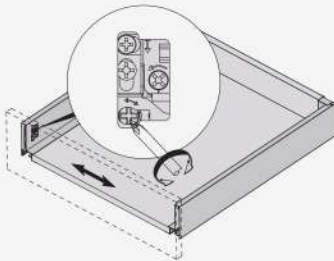

Ρύθμιση αριστερά/δεξιά $\pm 1,5\text{mm}$

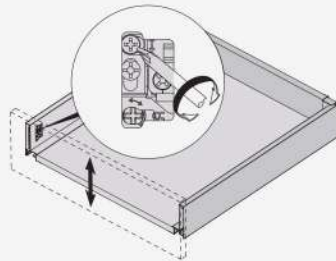

Ρύθμιση πάνω/κάτω $\pm 2\text{mm}$

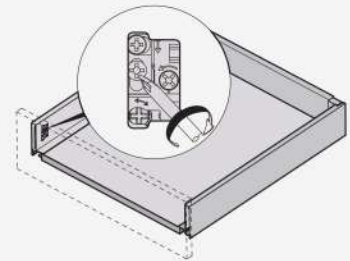

Κλειδαριά

Κλειδώστε και αφαιρέστε τον πίνακα

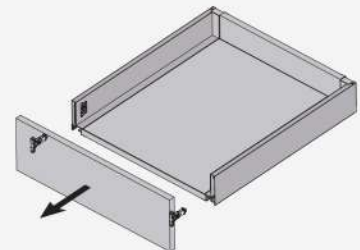
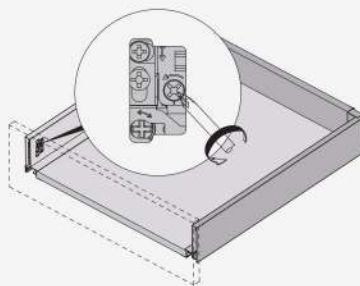
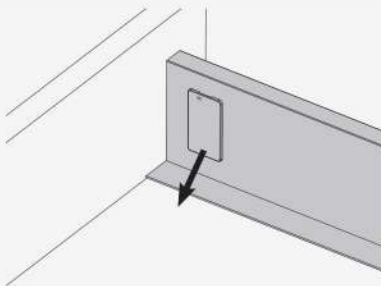

Τοποθετήστε και αφαιρέστε το συρτάρι

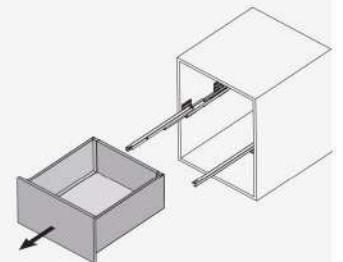
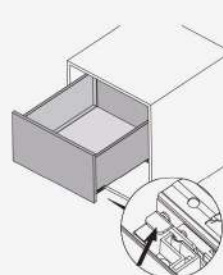
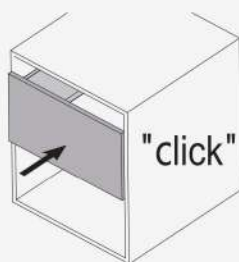
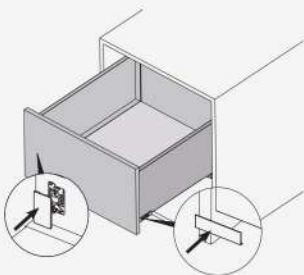

Τοποθετήστε το μπροστινό πλαίσιο του εσωτερικού συρταριού

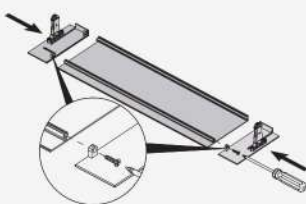

H84 ύψος

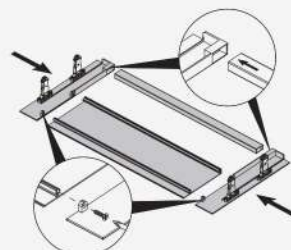

H167&H199 ύψος

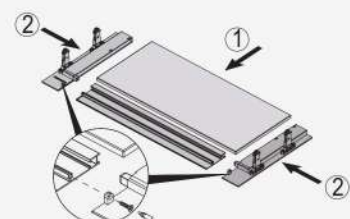

H167&H199 ύψος